



# On Broadway

## Downtown Redwood City High Profile Anchor Space

### NOW LEASING

<u>SPACE#</u>	<u>SF</u>	<u>RENT</u>	<u>NNN</u>
K (former Cost Plus)	18,000	\$24 psf	\$9.44

For information, contact:

**Courtney Jones**, CA BRE #01232209  
[cjones@crosspointrealty.com](mailto:cjones@crosspointrealty.com)

**Thomas N. Klein**, CA BRE #00840486  
[tklein@crosspointrealty.com](mailto:tklein@crosspointrealty.com)

Phone: 415-288-6888  
Fax: 415-288-6877

Crosspoint Realty Services, Inc.  
303 Sacramento Street, 3<sup>rd</sup> Floor  
San Francisco, CA 94111  
[www.crosspointrealty.com](http://www.crosspointrealty.com)



### SITE PLAN

Contact: Courtney Jones (CA BRE#01232209), [cjones@crosspointrealty.com](mailto:cjones@crosspointrealty.com); Thomas N. Klein (CA BRE#00840486), [tklein@crosspointrealty.com](mailto:tklein@crosspointrealty.com) Phone 415.288.6888

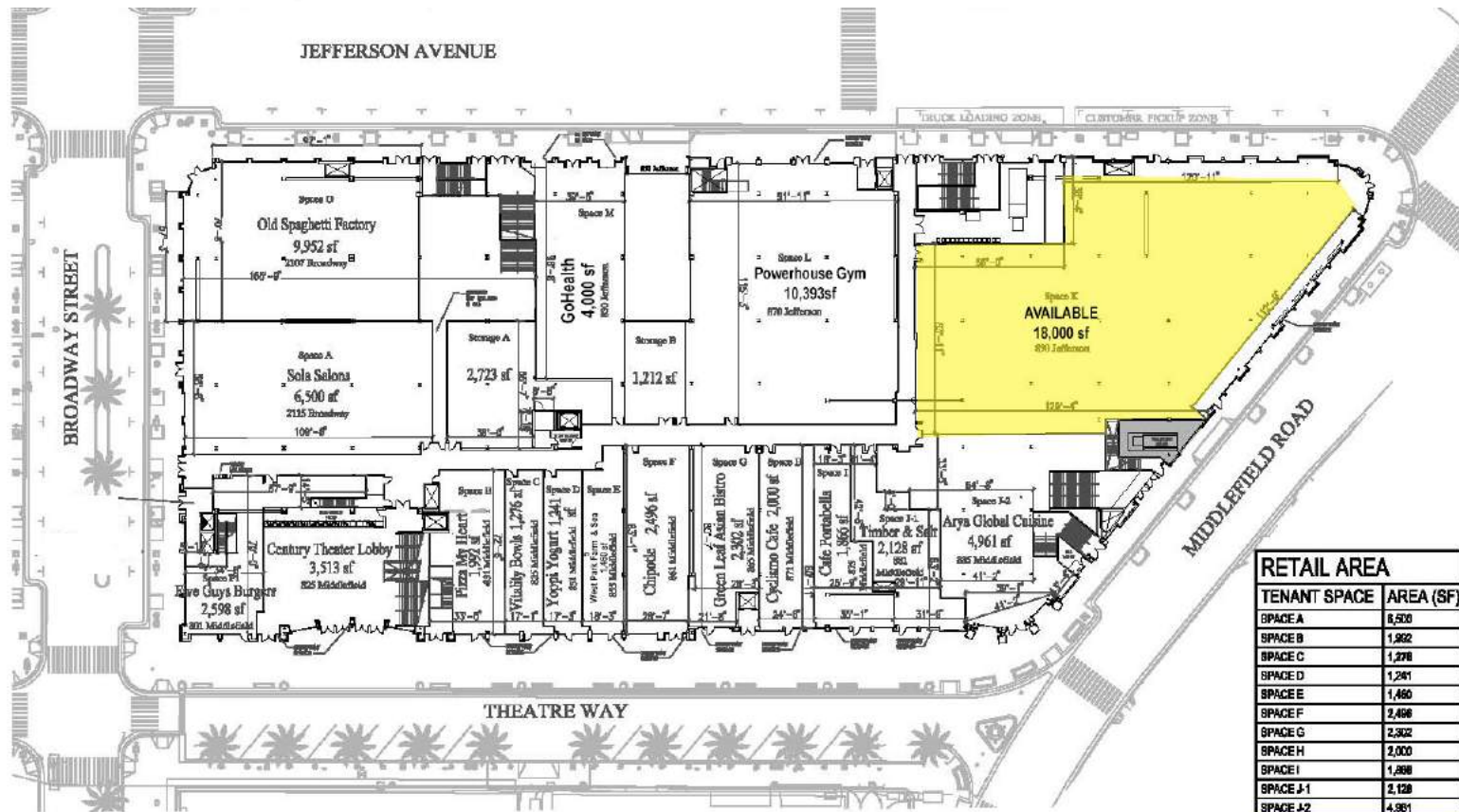

RETAIL AREA	
TENANT SPACE	AREA (SF)
SPACE A	6,500
SPACE B	1,992
SPACE C	1,278
SPACE D	1,281
SPACE E	1,460
SPACE F	2,468
SPACE G	2,932
SPACE H	2,000
SPACE I	1,888
SPACE J-1	2,128
SPACE J-2	4,981
SPACE K	18,000
SPACE L	10,383
SPACE M	4,000
SPACE O	8,982
SPACE P1	2,598
SPACE P2 (UPSTAIRS)	3,889
<b>SUBTOTAL</b>	<b>76,854</b>

CENTURY THEATRE	
TENANT SPACE	AREA (SF)
THEATRES & CONCESS.	67,476
BOX OFFICE	442
<b>SUBTOTAL</b>	<b>67,918</b>
<b>TOTAL GLA</b>	<b>144,772</b>

### ON BROADWAY FIRST FLOOR LEASE PLAN

REDWOOD CITY, CA      APRIL 7, 2015

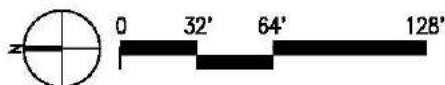

Deutsche Asset & Wealth Management

**DISCLAIMER:**  
THIS SITE PLAN IS INTENDED ONLY TO SHOW THE GENERAL LAYOUT OF THE PROPERTY OR A PART THEREOF. LANDLORD RESERVES THE RIGHT TO ALTER, VARY, ADD OR OMIT IN WHOLE OR IN PART ANY STRUCTURES, AND/OR IMPROVEMENTS, TENANT NAMES, STORE SIZES AND/OR LAND AREA SHOWN ON THIS PLAN. ALL MEASUREMENTS AND DISTANCES ARE APPROXIMATE. THIS PLAN IS NOT TO BE SCALED.

**FOR LEASING INFORMATION:**  
Tom Klein & Courtney Jones  
Crosspoint Realty Services, Inc.  
280 California Street  
San Francisco, CA 94111  
[www.crosspointrealty.com](http://www.crosspointrealty.com)  
P: 415.288.6888 F: 415.288.6877



### SPACE PLAN

Contact: Courtney Jones (CA BRE#01232209), [cjones@crosspointrealty.com](mailto:cjones@crosspointrealty.com); Thomas N. Klein (CA BRE#00840486), [tklein@crosspointrealty.com](mailto:tklein@crosspointrealty.com) Phone 415.288.6888

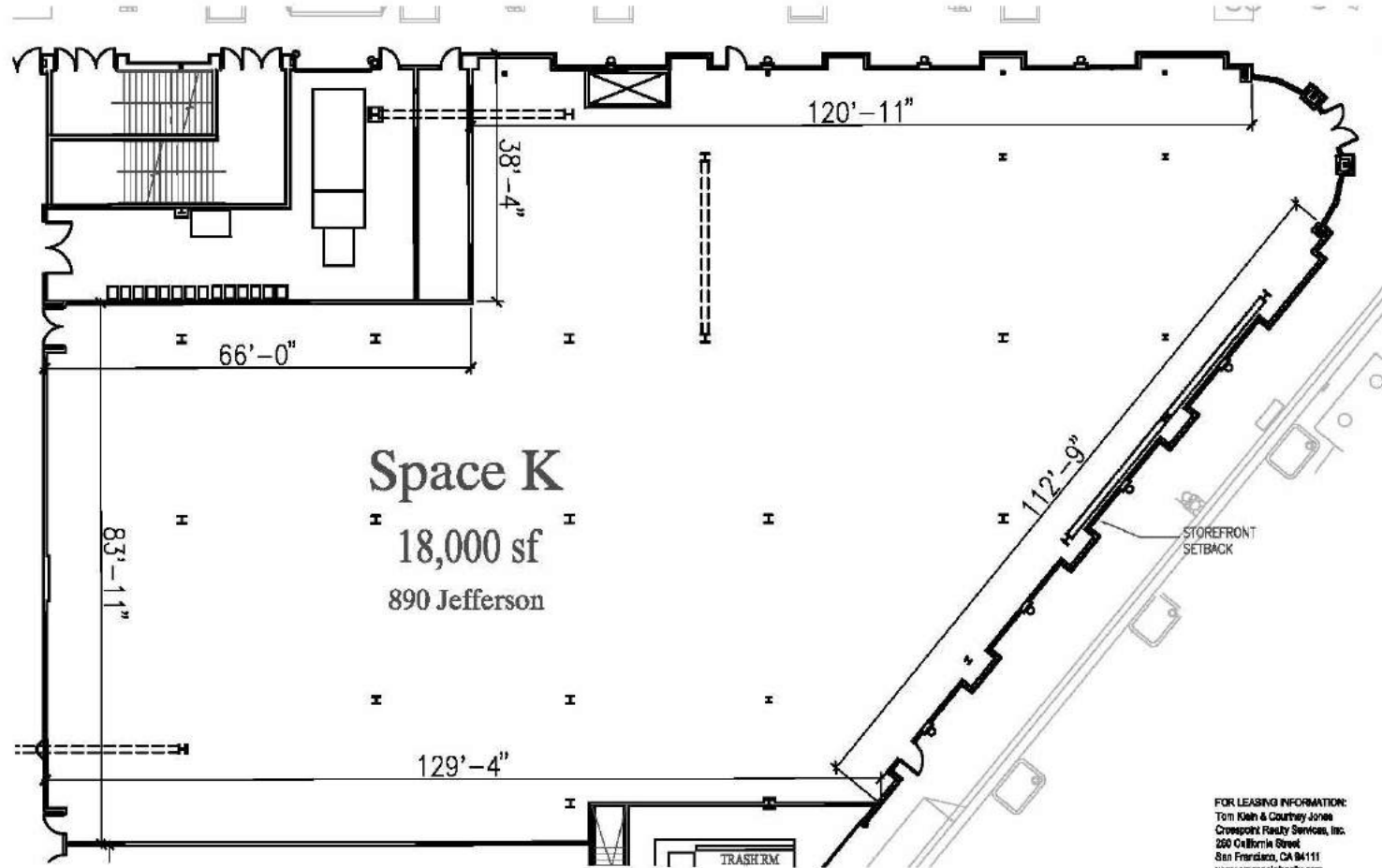

FOR LEASING INFORMATION:  
Tom Klein & Courtney Jones  
Crosspoint Realty Services, Inc.  
320 California Street  
San Francisco, CA 94111  
[www.crosspointrealty.com](http://www.crosspointrealty.com)  
P: 415.288.6888 F: 415.288.6877

**ON BROADWAY SPACE K - LEASE PLAN**  
REDWOOD CITY, CA May 13, 2016

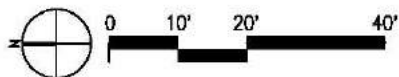

Deutsche Asset & Wealth Management

**DISCLAIMER:**  
THIS SITE PLAN IS INTENDED ONLY TO SHOW THE GENERAL LAYOUT OF THE PROPERTY OR A PART THEREOF. LANDLORD RESERVES THE RIGHT TO ALTER, VARY, ADD OR OMIT IN WHOLE OR IN PART ANY STRUCTURES, AND/OR IMPROVEMENTS. TENANT NAMES, STORE SIZES AND/OR LAND AREA SHOWN ON THIS PLAN. ALL MEASUREMENTS AND DISTANCES ARE APPROXIMATE. THIS PLAN IS NOT TO BE SCALED.

# On Broadway

## Jefferson Ave & Broadway | Redwood City, California

### MARKET AREA

#### On Broadway Tenants Include:

- |                      |                         |
|----------------------|-------------------------|
| Century Theaters 20  | Old Spaghetti Factory   |
| Powerhouse Gym       | Five Guys Burgers       |
| Vitality Bowls       | Cyclismo Cafe           |
| Yoho Yogurt          | Sola Salons             |
| Café Portabella      | Green Leaf Asian Bistro |
| Chipotle             | Timber & Salt           |
| West Park Farm & Sea | Go Health Urgent Care   |
| Pizza My Heart       | Silicon FinTech Bay     |

#### For information, contact:

**Courtney Jones**, CA BRE #01232209  
[cjones@crosspointrealty.com](mailto:cjones@crosspointrealty.com)

**Thomas N. Klein**, CA BRE #00840486  
[tklein@crosspointrealty.com](mailto:tklein@crosspointrealty.com)

Phone: 415-288-6888  
Fax: 415-288-6877

Crosspoint Realty Services, Inc.  
303 Sacramento Street, 3<sup>rd</sup> Floor  
San Francisco, CA 94111  
[www.crosspointrealty.com](http://www.crosspointrealty.com)

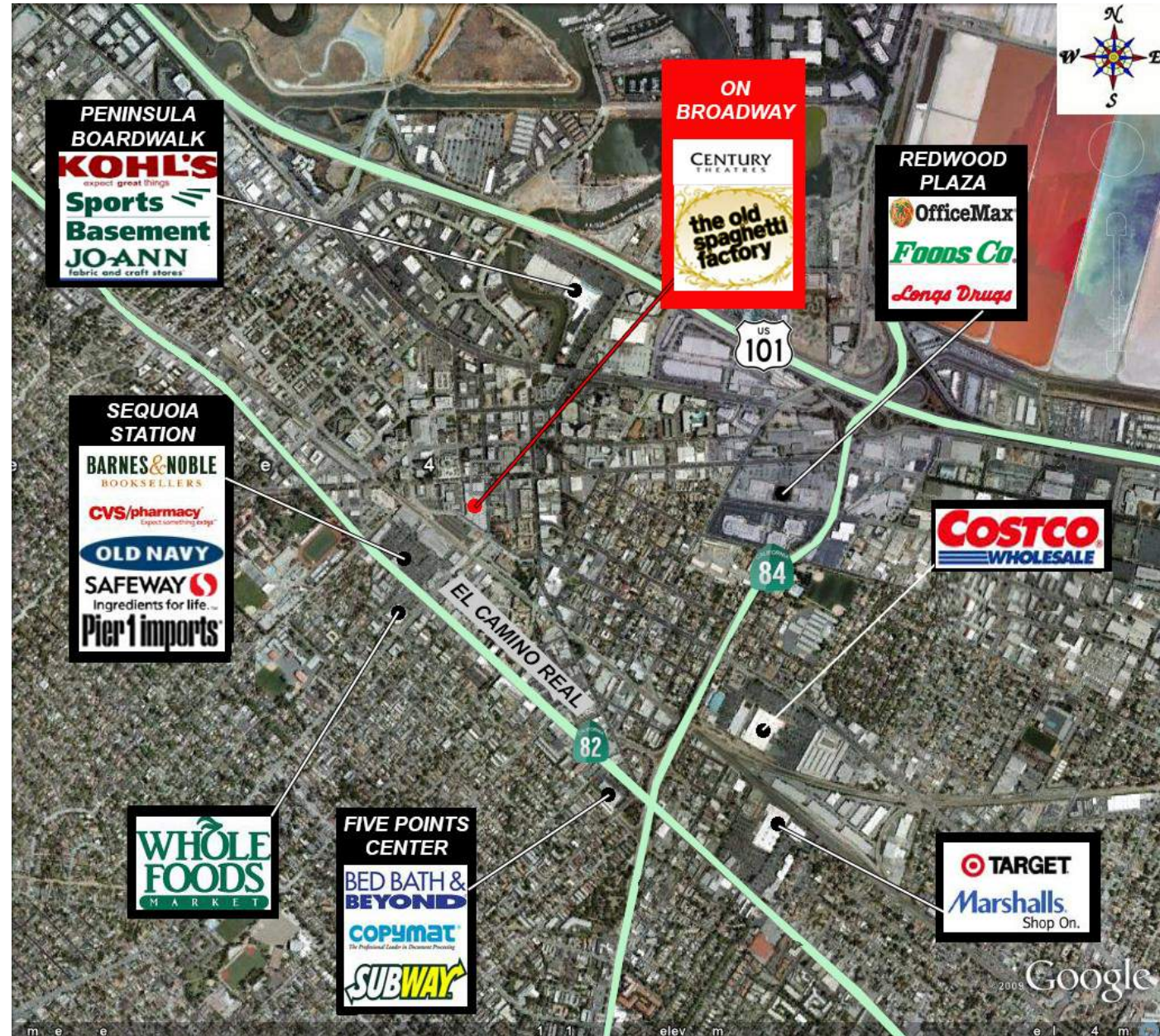

# On Broadway

## Jefferson Ave & Broadway | Redwood City , California

### MAP & INFORMATION

Contact: Courtney Jones (CA BRE#01232209), [cjones@crosspointrealty.com](mailto:cjones@crosspointrealty.com); Thomas N. Klein (CA BRE#00840486), [tklein@crosspointrealty.com](mailto:tklein@crosspointrealty.com) Phone 415.288.6888

#### Description:

On Broadway is a 145,000 square foot entertainment retail center anchored by a state of the art, 20 screen Century Theater complex in vibrant downtown Redwood City. Jefferson Avenue is the main artery into downtown Redwood City from El Camino Real and the available 18,000 sf space anchors the Jefferson Avenue / Middlefield Road corner. Theater Way borders the north side of the project and includes numerous popular restaurants. The project also includes 585 easily accessible subterranean parking spaces.

#### Location:

Jefferson Avenue & Broadway Street, Redwood City, CA

